

Grade 80

Lang øjebolt med krave / Long Eye Bolt with Collar

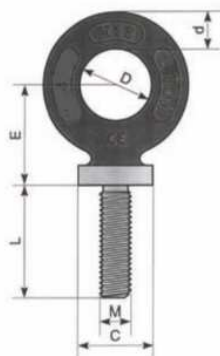

Godkendt til løft

Approved for lifting

Art No.	WLL tons	Size mm	C mm	D mm	d mm	E mm	L mm	Weight Kg
810825	0,4	M8x25	18	20	8,30	26	25	0,06
811030	0,7	M10x30	20	22	10,20	30	30	0,10
811237	1,0	M12x37	25	27	12,60	36	37	0,18
811654	1,5	M16x54	36	35	17,00	47	54	0,43
812058	2,5	M20x58	40	39	18,50	52	58	0,63
812464	4,0	M24x64	55	54	22,50	64	64	1,32

Safetyfactor 4:1	Single point		Two point		Four point	
	0°	0°	0 - 45°	45° - 60°	0 - 45°	45° - 60°
Angle of inclination	0°	0°	0 - 45°	45° - 60°	0 - 45°	45° - 60°
Size						
M8 x25	0,40	0,80	0,14	0,10	0,20	0,14
M10 x 30	0,70	1,40	0,25	0,18	0,35	0,25
M12 x 37	1,00	2,00	0,35	0,25	0,50	0,35
M16 x 54	1,50	3,00	0,53	0,38	0,75	0,53
M20 x 58	2,50	5,00	0,86	0,63	1,25	0,86
M24 x 64	4,00	8,00	1,40	1,00	2,00	1,40

Grade 100

Svirvel øjebolt, med nøgle / Eye Bolt Swivel, with Key



360° Rotation

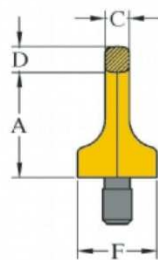
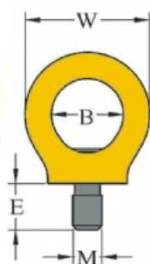

Godkendt til løft i alle retninger med max belastning

Approved for lifting in all directions with max load

Art No.	Size	WLL Kg	A mm	B mm	C mm	D mm	E mm	F mm	W mm	Weight Kg
8291K003	M8	300	36	25	8	11	12	25	44	0,1
8291K004	M10	400	36	25	8	11	15	25	44	0,1
8291K007	M12	750	42	30	10	13	18	33	52	0,2
8291K015	M16	1500	51	35	14	13	24	35	51	0,3
8291K023	M20	2300	57	40	16	17	30	44	70	0,6
8291K032	M24	3200	70	48	19	21	36	52	84	1,0
8291K045	M30	4500	86	60	24	26	45	62	108	1,8
8291K070	M36	7000	103	72	29	32	54	78	130	3,2
8291K090	M42	9000	120	82	34	38	63	88	150	5,0
8291K120	M48	12000	137	94	38	43	72	104	168	7,6